



EQP-122
POWER BOOST & POWER BANK
USER'S GUIDE



EQP-122

POWER BOOST & POWER BANK

USER'S GUIDE

Thank you for choosing the EQP-122.
 Always follow basic safety precautions when using electrical appliances. Read all instructions carefully. Please keep this instruction manual for easy reference.

A. PRODUCT LAYOUT:

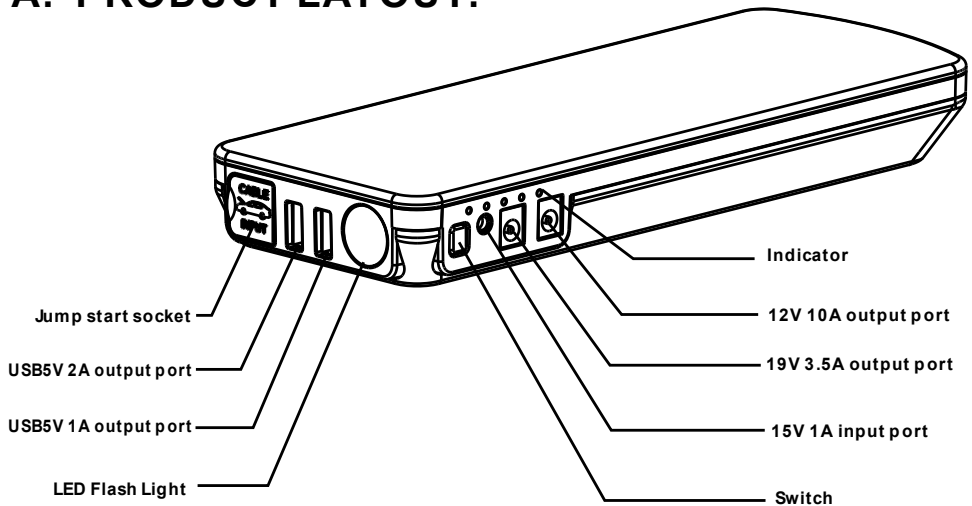

15V 1A input port

Home adaptor



Car adaptor



Jump start socket

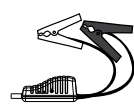



Jumper cable with clamps



19V 3.5A output port

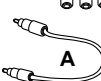

A

USB5V 2A output port

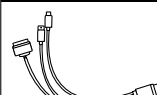

B



12V 10A output port

For 12V vehicle products



B. OPERATION GUIDANCE

Indicator

Press the switch to check the storage level of EPower

Indicator	Unlit	5 Flashing	1 solid	2 solid	3 solid	4 solid	5 solid
Storage level	0%	10%	20%	40%	60%	80%	100%

The indicators will flash one by one during the period of charging. The number of solid indicators shows different storage levels of the EQP-122. All indicators turn off when the charging is paused or completed.

EQP-122 Charging Instructions:

1. Plug the home adaptor into the universal socket.
2. Connect 15V 1A input port of the EQP-122 to the other end of home adaptor.

Or

1. Plug the car adaptor into the socket of cigarette lighter.
2. Connect 15V 1A input port of the EQP-122 to the other end of car adaptor.

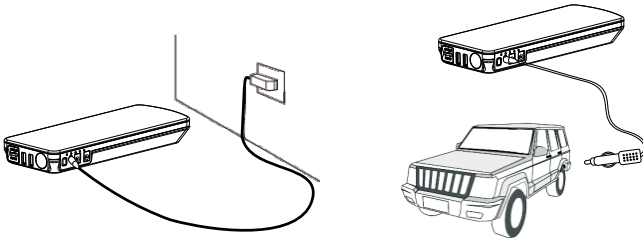

Jump start 12V vehicle Instruction:

1. Connect the blue plug fully seated into the host, and make sure the Cable Indicator is off.
2. Connect Red Clamp to the positive (+) battery terminal, Black Clamp to the negative (-) battery terminal.
3. Operate following the instruction of the Cable Indicator:

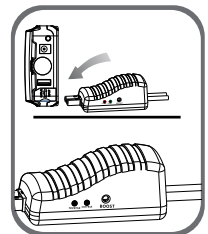

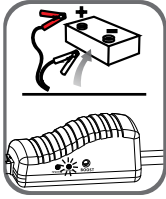

GREEN LIGHT on:
Telling the connection is correct and the circuit is working, you can turn on the engine to jump-start directly.

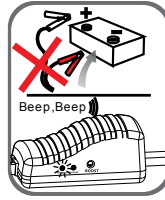

RED LIGHT on with buzzing: Telling the connection is wrong, and buzzing to alarm to correct the clamps as step 2 mentioned above, wait until the GREEN LIGHT is on to turn on the engine.

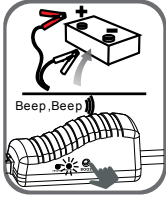

GREEN LIGHT blinking with buzzing: Saying the vehicle battery is low, press the "BOOST" button, wait GREEN LIGHT becomes solid, then turn on the engine within 30s.

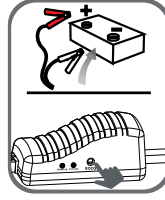

No Lights on, No buzzing: Saying the vehicle's battery maybe damaged, after confirm the clamps connection is correct, press the "BOOST" button, wait GREEN LIGHT is on, and then turn on the engine within 30s.

4. Start the vehicle.

5. When the vehicle is started, remove the jumper cable from the vehicle battery. Leave the vehicle's engine running.

Charging Cell Phone or Tablet Instruction:

1. Plug the switch cable B to USB 5V 2A output port.
2. Select appropriate connector and connect it to your mobile phones or tablet.
3. Press the switch button to charge.
4. If doesn't work, please try another USB Output port.

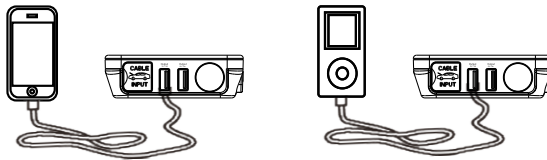

Only for charging/power supply to 19V Notebook

1. Plug the switch cable A to USB 19V 3.5A output port.
2. Select appropriate connector for your Notebook and connect it to the switch cable A and your Notebook.
3. Press the switch button to charge/power supply.

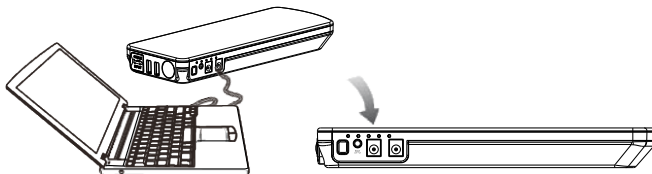

For power supply to 12V vehicle products or 12V electronics:

1. Plug the optional switch cable to 12V 10A output port.
2. Connect the optional switch cable and 12V vehicle product or 12V electronics.
3. Press the switch button to power supply.

LED flash light:

Press the switch 3 seconds to start the LED flash light.

The four modes of LED light appear in order

(NORMAL / STROBE / SOS / OFF) if you press slightly.

C. PARTS LIST :

#	Parts Name	Quantity	#	Parts Name	Quantity
1	Host	1	5	Home adaptor	1
2	Switch cable A	1	6	Car adaptor	1
3	Switch cable B	1	7	Intelligent jumper cable	1
4	Notebook connector	8	8	User Manual	1

D. TECHNICAL SPECIFICATIONS

Size : 230*87*27mm
Weight : 615g
Battery Capacity: 18000mAh (66.6Wh)
Output: 5V $\overline{=}$ 1A;5V $\overline{=}$ 2A; 12V $\overline{=}$ 10A; 19V $\overline{=}$ 3.5A;
Input : 15V $\overline{=}$ 1A
Full charging time : 8 hours
Starting current : 300A
Peak current : 600A
Operating temperature : -20°C ~ 60°C

E. FAQ :

Q. How to turn off this appliance?

A. This appliance will power off automatically when there is no load or charging is complete.

Q. How long to fully charge the EQP-122?

A. Approx. 8 hours through the 15V1A input.

Q. How many times can this appliance charge for my cell phone?

A. Depend on the battery capacity of your cell phone. Take iPhone4 as an example, can full charging 14 times.

Q. How long will this appliance take to charge my cell phone fully?

A. Approx. 1 hour

Q. How long will this appliance on a full charge take to supply the Notebook?

A. 4-6 hours

Q. How many times can this appliance jump start the vehicle if it is in full if it is fully charged?

A. Approx. 40 times.

Q. What's the lifetime of EQP-122?

A. Usually 3-5 years in normal conditions.

Q. How long does the battery last after fully charged?

A. 6-12 months, however, we suggest to recharge it every 3 months.

Q. How long can the battery still jump start a vehicle after being fully charged?

A. 6-12 months.

F. TROUBLE SHOOTING:

Finding	Cause	Remedies
No response when pressing the switch button.	Low voltage protection of EPower is started.	Plug the adaptor into the 15V 1A input port to activate.
EQP-122 is a bit hot when charging a Notebook.	The charging current is a bit high (3.5A)	Remove the battery of your Notebook and use this appliance to supply power directly or disconnect the EQP-122 from your Notebook and reconnect when it is cool.

G. TOXIC AND HARMFUL SUBSTANCES:

Composition and amount of toxic and harmful substances in the EQP-122					
Pb	Hg	Cd	C r(Vi)	PBB	PBDEB
○	○	○	○	○	○
○ : Indicate all homogeneous materials' hazardous substances content are below the MCV limit specified in the Standard 2002/95/EC(RoHs).					

H. Warning:

1. Always ensure the blue plug of jumper cable is tightly connected to the jump start socket in the EQP-122 before jump starting the vehicle. Otherwise, it will affect the results, even causing the blue plug to melt.
2. Always check the jumper clamps are well connected, check if the vehicle battery connector is rusted or dirty, clean it before jumping start the vehicle. DO NOT jump start again after 3 attempts. Otherwise, it will damage the host. And Check your vehicle if it has other trouble.
3. DO NOT connect the two clamps. It may be dangerous!
4. DO NOT disassemble the host. It may be dangerous!



Always take care when using the appliance.



This appliance is not intended for use by young or infirm persons without supervision.



Do not use as a toy.



Do not allow the appliance to become wet.

Do not immerse the appliance in water.



Do not operate the appliance in explosive atmospheres, such as in the presence of flammable liquids, gases or dust.



Do not modify or disassemble EQP-122. Only a repair technician may repair this unit.



Do not expose the appliance to heat.

Do not store in locations where the temperature may exceed 70 °C.



Charge only at ambient temperatures between -20 °C and 60 °C.

Charge only using the charger provided with the appliance.



Under extreme conditions, battery leakage may occur. Carefully wipe the liquid off using a cloth and avoid skin contact when you notice liquid on the batteries. In case of skin or eye contact, rinse immediately with clean water and seek medical attention.



At the end of their useful life, discard the appliance with due care for our environment.

I. WARRANTY INFORMATION:

We offer a limited warranty for this product against any defects in material and workmanship for a period of 12 months from the date of purchase by the end user/consumer. The conditions of the warranty are as follows:

1. The warranty is only valid upon presentation of the original receipt (from dealer/retailer) by the original purchaser with the product to be repaired or replaced.
2. The warranty is void if the serial number, date of purchase or label has been removed.
3. The warranty does not cover damage or product failure resulting from normal wear and tear, physical abuse, improper installation, misuse, modification or repairs by unauthorised third parties.
4. We do not assume responsibility for any loss or damage incurred during shipment or as a result of a force majeure.
5. We are not liable for any incidental or consequential damages arising from the use or misuse of this product.
6. All warranty claims are limited to repair or replacement of the defective product and at the sole discretion of us.
7. If we repair or replace the product, the product will be covered for the remaining time of the original warranty period. Repair or replacement may involve the use of reconditioned units which are equivalent in function. Replaced part or product becomes the property of us.
8. Consumable components such as batteries are not covered by the warranty.

The switch cables that come with the unit are for testing ONLY, and are of no commercial value. All rights reserved.



Overcharge and
Overdischarge Protection



Fuse Protection



Anti-Reverse Plug

Applied Standard : GB/T 18287-2000



PLUS+QUIP

■ **Quality Products** ■ **12 Month Warranty** ■ **Technical Support**
Available from leading automotive specialists and retailers.

www.plusquip.com.au